

Typ: Crimpeinsatz-Set CS 30-Ultra Fast/AWG 10-12
Code-Nr.: 1863-08102

Crimpeinsätze
Crimp dies

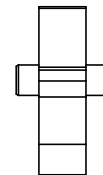
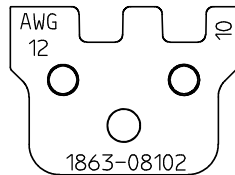
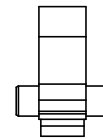
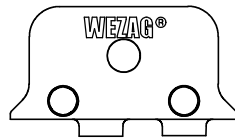

Alle Rechte an diesem Dokument liegen bei
WEZAG GmbH, WERKZEUGFABRIK 35260 Stadtlendorf

Anwendungsbereich:
Application range:

Profil Profile	Leiterquerschnitt Cross section range AWG	Crimphöhe Leiter Crimp height wire	Crimpbreite Leiter Crimp width wire	Kontakt-Typ: Contact Type:	Kontakt-Nr.: Contact No.:
1	12			Ultra-Fast Faston	
2	10			Ultra-Fast Faston	