

Type: CS30-Crimpeinsatz-Set IWFS 0,5-2,5  
CS30-Die Set IWFS 0,5-2,5

Code-No: 1868-63103

WDT-Type: I/W 0525

Ausführung:  
Workmanship:

- Leichte Handhabung  
Easy handling
- Einfache Kontaktpositionierung  
Easy contact positioning
- Präzise geschliffene Profile  
Precisely ground profiles
- Oberfläche brüniert  
Burnished surface
- Voll recylefähig:  
RoHS (Richtlinie.2002/95/EG) konform  
Fully recyclable:  
RoHS (Directive.2002/95/EG) complaint

Crimpstempel, komplett  
crimp punch, complete  
1868-63002

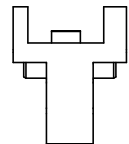
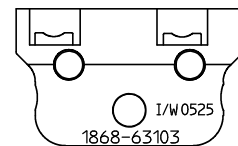
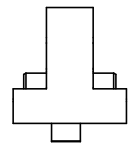
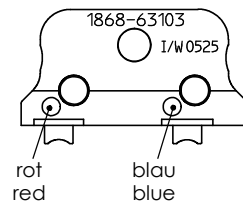

Crimpamboß, komplett  
crimp anvil, complete  
1868-63001

Patent Crimpeinsatz  
Patent Die Set  
DE 198 02 287  
US 6,053,025

Anwendungsbereich:  
Application range:

	Leiterquerschnitt Cross section range mm <sup>2</sup>	Leiterquerschnitt Cross section range AWG	Kontakt-Typ: Contact-Type:
rot red	0,5 - 1,5	22 - 18	isolierte Winkelflachstecker F6,3 insulated flag terminals F6,3
blau blue	1,5 - 2,5	16 - 14	