

Type: EHC 10-Eins. KS 70 mm²

Code-No: 1880-60122

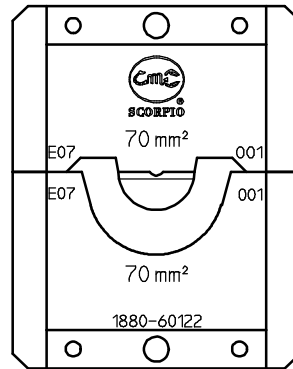

Crimpstempel 2480-60023
Crimp punch 2480-60023

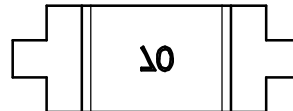
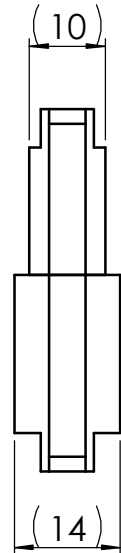

**Ausführung:
Workmanship:**

- Präzise geschliffene Profile
Precisely ground profiles
- Aus hochfestem Spezialstahl
High tempered steel
- Oberfläche brüniert
Burnished surface
- Voll recyclefähig;
RoHS(Richtlinie.2002/95/EG) konform
Fully recyclable;
RoHS(Directive.2002/95/EG) compliant

**Abmessungen:
Dimensions:**

- Länge: ca. 48 mm
Length: approx. 48 mm
- Breite: ca. 38 mm
Width: approx. 38 mm
- Gewicht: ca. 120 g
Weight: approx. 120 g

**Anwendungsbereich:
Application range:**

Leiterquerschnitt Cross section range mm ²	Kontakt-Typ: Contact Type:
70	Quetschkabelschuh DIN 46234 - 70 mm ² Ring tongue terminal DIN 46234 - 70mm ²