

**Typ: Crimpeinsatz-Set EHC 10/CS40 DIN-Eins. KKS 10-16 mm²
Code-Nr.: 1880-60128**

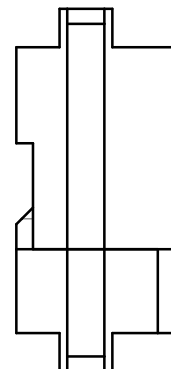
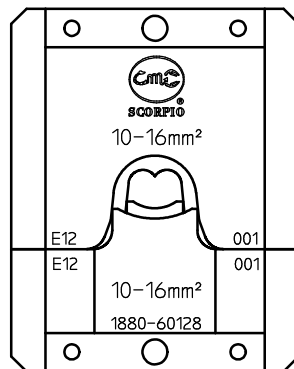

**Ausführung:
Workmanship:**

- Präzise geschliffene Profile
Precisely ground profiles
- Aus hochfestem Spezialstahl
High tempered steel
- Oberfläche brüniert
Burnished surface
- Voll recyclefähig;
RoHS(Richtlinie.2002/95/EG) konform
Fully recyclable;
RoHS(Directive.2002/95/EG) compliant

**Abmessungen:
Dimensions:**

- Länge: ca. 50 mm
Length: approx. 50 mm
- Breite: ca. 38 mm
Width: approx. 38 mm
- Gewicht: ca. 160 g
Weight: approx. 160 g

**Anwendungsbereich:
Application range:**

Leiterquerschnitt Cross section range mm ²	Crimphöhe Leiter Crimp height wire ±0,1	Crimphöhe Isolation Crimp height insulation ±0,2	Kontakt-Typ: Contact-type:
10-16	5,2	8,5	Krallenkabelschuh 10-16 mm ² Clamp terminal 10-16 mm ²